

- > **Port size: 1/2" or 3/4" (ISO G/PTF)**
- > **Excelon design allows in-line or modular installation**
- > **Manifold typically up to six regulators without booster signal**
- > **Balanced valve design for optimum pressure control**
- > **Push to lock adjusting knob with tamper resistant accessory**



Technical features

Medium:

Compressed air only

Maximum operating pressure:

20 bar (300 psi)

Two inlet ports:

G1/2 or G3/4 ISO G

1/2 or 3/4 PTF

One outlet port:

G1/2 ISO G

1/2 PTF

One gauge port:

Rc 1/8 with ISO G main ports

1/8 PTF with PTF main ports

Flow:

105 dm³/s maximum

At port size: 1/2"

Inlet pressure 10 bar (145 psi);

6,3 bar (91 psi) set pressure and a

Δp: 1 bar (14,5 psi) droop from set.

Ambient/Media temperature:

-34° ... +80°C (-30° ... +176°F)

Version with gauge:

-34° ... +65°C (-30° ... +149°F)

Air supply must be dry enough

to avoid ice formation at

temperatures below +2°C (+35°F).

Materials:

Body: Aluminum

Bonnet: Aluminum

Elastomers: NBR

Bottom plug: Acetal

Technical data - standard models - diaphragm

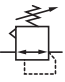
Symbol	Inlet port (2)	Outlet port (1)	Size	Pressure range (bar)	Adjustment	Weight (kg)	Model
	G1/2	G1/2	Basic	0,3 ... 10	Knob	0,80	R74M-4GK-RMN
	G3/4	G1/2		0,3 ... 10	Knob	0,78	R74M-6GK-RMN

Option selector

Port size	Substitute
1/2"	4
3/4"	6
Thread form	Substitute
PTF	A
ISO G parallel	G
Adjustment	Substitute
Knob (standard)	K
T-bar	T *1)

R74M-★★★★★★

Gauge	Substitute
With	G
Without (standard)	N
Outlet pressure adjustment range *2)	Substitute
0,3 ... 4 bar	F
0,3 ... 10 bar (standard)	M
0,7 ... 17 bar	S *1)
Diaphragm	Substitute
Relieving (standard)	R
Non relieving	N

*1) Units with 17 bar outlet pressure range are available only with the T-bar adjustment; therefore substitute T at the 7th position and S at the 9th position.

*2) Outlet pressure can be adjusted to pressures in excess of, and less than, those specified. Do not use these units to control pressures outside of the specified ranges.

Flow characteristics



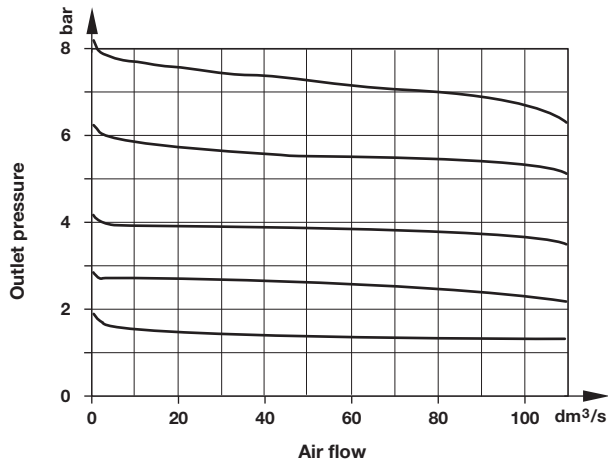



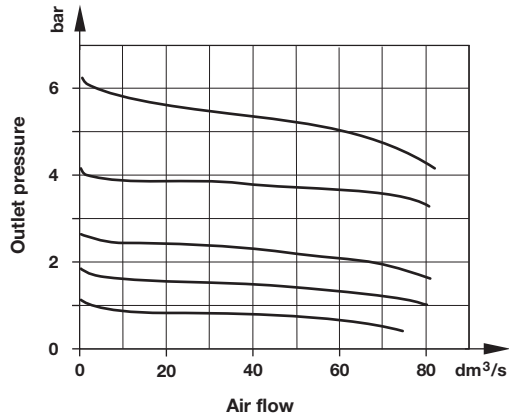



Inlet pressure: 10 bar (145 psi)
Port size: 1/2"



Inlet pressure: 7 bar (101 psi)
Port size: 1/2"





Accessories

<p>Wall mounting bracket</p>  <p>Page 4 4324-50</p>	<p>Quikclamp®</p>  <p>Page 3 4314-51</p>	<p>Quikclamp with wall bracket®</p>  <p>Page 3 4314-52</p>	<p>Wall mounting bracket</p>  <p>Page 4 4368-51</p>	<p>Panel nut</p>  <p>4348-89</p>	<p>Tamper resistant kit</p>  <p>4355-51</p>
<p>Quikmount pipe adaptor *1)</p>  <p>Page 3 G3/8: 4315-10 G1/2: 4315-11 G3/4: 4315-12 3/8 PTF: 4315-02 1/2 PTF: 4315-03 3/4 PTF: 4315-04</p>	<p>Porting block with three alternative 1/4" ports</p>  <p>Page 3 G1/4: 4316-52 1/4 PTF: 4316-50</p>	<p>2/2 Shut-off valves (for full technical specification see datasheet 8.200.600)</p>  <p>Page 4 G 3/8: T74B-3GA-P1N G 1/2: T74B-4GA-P1N G 3/4: T74B-6GA-P1N 3/4 PTF: T74B-6AA-P1N</p>	<p>3/2 Shut-off valves (for full technical specification see datasheet 8.200.600)</p>  <p>Page 4 G 3/8: T74T-3GA-P1N G 1/2: T74T-4GA-P1N G 3/4: T74T-6GA-P1N 1/2 PTF: T74T-4AA-P1N 3/4 PTF: T74T-6AA-P1N</p>		

*1) Please use a Quikmount pipe adaptor if the Quikclamp be mounted at inlet or outlet side.

Pressure switch

<p>Porting block for pressure switch</p>  <p>Page 4 0523110000000000</p>	<p>Pressure switch (0,5 ... 8 bar)</p>  <p>0881300000000000</p>	<p>Padlock (brass) with two keys *1)</p>  <p>0613633000000000</p>
--	---	---

*1) For shut-off valves and tamper resistant kit

Service kits

<p>Service kit</p>  <p>4381-700</p>

Gauge

Center connection,
 black face
 (for full technical
 specification
 see datasheet
 8.900.900)



Pressure range psig *1) bar	MPa	Ø	Thread size	Model
0 ... 58 0 ... 4	0 ... 0,4	38 mm	R1/8	18-013-277
0 ... 145 0 ... 10	0 ... 1	38 mm	R1/8	18-013-279
0 ... 362 0 ... 25	0 ... 2,5	38 mm	R1/8	18-013-280

*1) primary scale

Center connection,
 black face
 for North America
 (for full technical
 specification
 see datasheet
 8.900.900)
 Pressure range



psig *1) bar	MPa	Ø	Thread size	Model
0 ... 60 0 ... 4	0 ... 0,4	1 1/2" (38 mm)	1/8 NPT	18-013-225
0 ... 160 0 ... 11	0 ... 1,1	1 1/2" (38 mm)	1/8 NPT	18-013-273
0 ... 300 0 ... 20	0 ... 2,1	1 1/2" (38 mm)	1/8 NPT	18-013-276

*1) primary scale

Drawings

Standard

T-bar

Dimensions in mm
 Projection/First angle

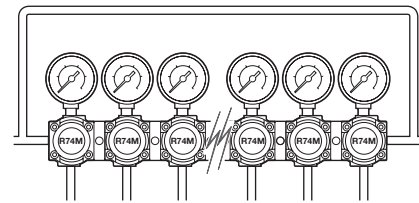
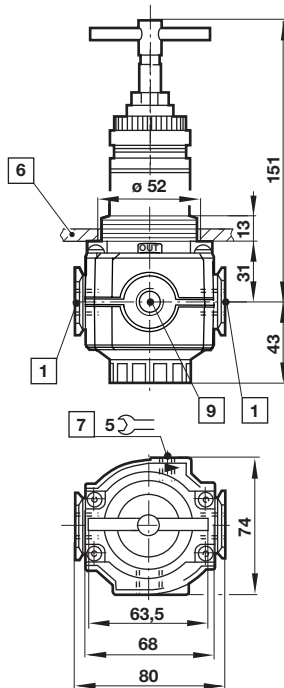
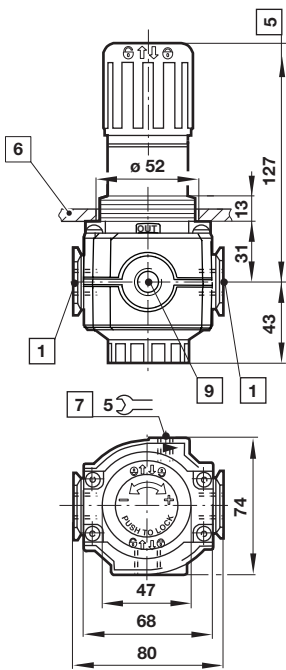

- 1 Inlet ports 3/8", 1/2" or 3/4"
- 5 Reduces by 4 mm with knob in locked position
- 6 Panel thickness 2 ... 6 mm
- 7 Gauge port Rc1/8 or 1/8 PTF plugged
- 9 Outlet port 1/2"

Accessories
Quikclamp®

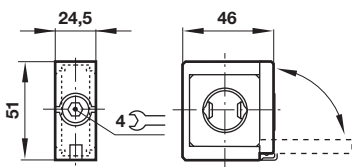

Quikclamp® with wall bracket

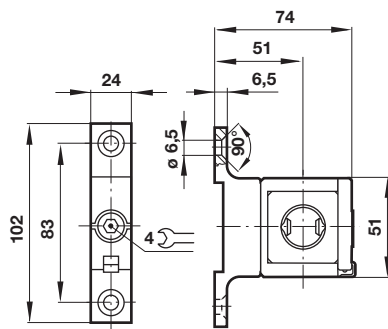

Porting block

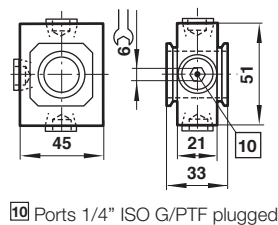

Pipe adapter

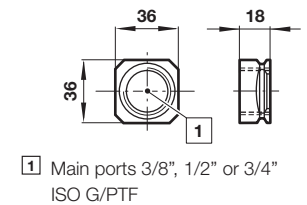

- 1 Main ports 3/8", 1/2" or 3/4" ISO G/PTF

- 10 Ports 1/4" ISO G/PTF plugged

Wall mounting bracket

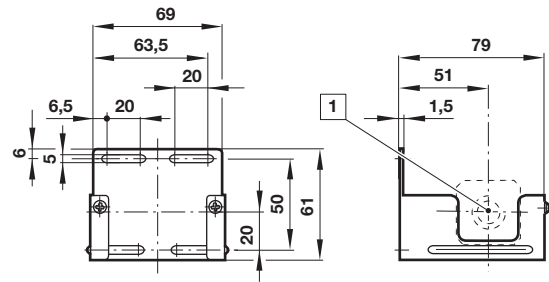

1 Main ports

Wall mounting bracket Shut-off valves

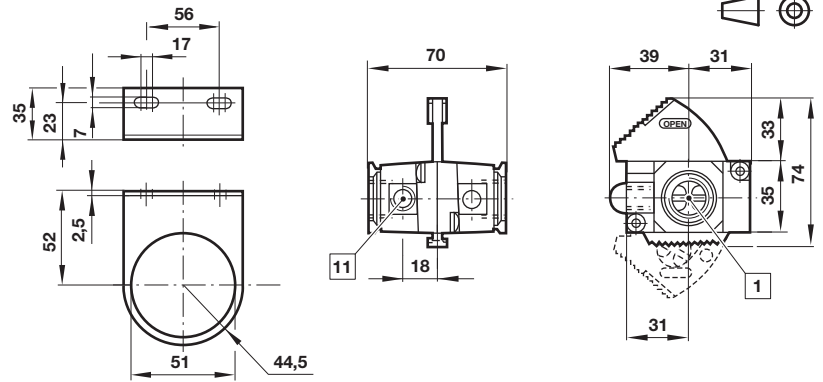

1 Main ports 3/8", 1/2" or 3/4" ISO G/PTF
11 Exhaust port Rc1/8 at 3/2 valve only

Dimensions in mm
Projection/First angle



Porting block for pressure switch

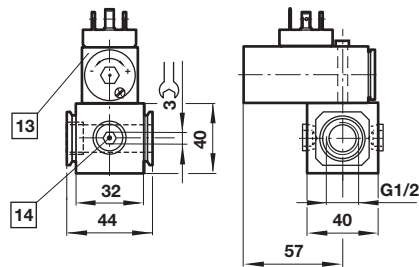

13 Pressure switch is not in scope of delivery
14 Alternative G1/4 ports plugged

Warning

These products are intended for use in industrial compressed air systems only. Do not use these products where pressures and temperatures can exceed those listed under

»Technical features/data«.

Before using these products with fluids other than those specified, for non-industrial applications, life-support systems or other applications not within published specifications, consult IMI Precision Engineering, Norgren Inc. Through misuse, age, or malfunction, components used in fluid power systems can fail in various modes.

The system designer is warned to consider the failure modes of all component parts used in fluid power systems and to provide adequate safeguards to prevent personal injury or damage to equipment in the event of such failure.

System designers must provide a warning to end users in the system instructional manual if protection against a failure mode cannot be adequately provided.

System designers and end users are cautioned to review specific warnings found in instruction sheets packed and shipped with these products.